

Reversion	Engineering	Change Description	Date	Owner
A/0		NEW	2016.08.02	ZXM

Electrical performance	
Characteristic impedance	50 Ω
Frequency range	DC to 8 GHz
Standing wave ratio(VSWR)	≤1.15 (DC~8GHz)
withstand voltage	≤0.1 x √f(GHz) dB
working voltage	335 V rms
Test voltage	1000 V rms
Insulation resistance	≥5000M Ω
Center pin contact resistance	≤3m Ω
Conductor contact resistance	≤2.5m Ω
Center conductor retention force	≥0.28N
Intermodulation 3rd order	N/A

Mechanical and environment	
Temperature range	-40~+155°C
Salt spray test time	48H
Airtight	N/A
durability	≥500 cycles

Materials		
Connector parts	Material	Plating
Socket	qBe	Au
Center contact	brass	Au
Outer contact	brass	CuSnZn
Dielectric	PTFE	

CAD GENERATED DRAWING,
DO NOT MANUALLY UPDATE

Any statements in this article shall not be interpreted as suggesting infringement of existing patents. Individual values may vary depending on factors including but not limited to application, design, cable type, assembly, and others workmanship

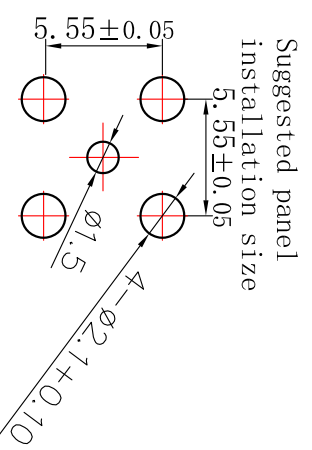
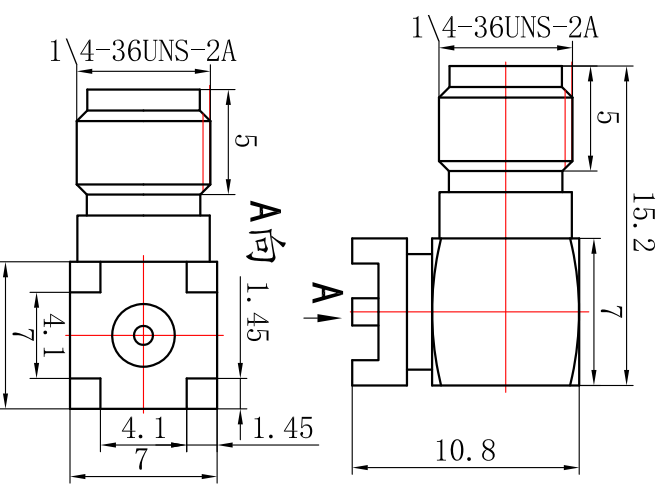

STANDARD TOLERANCES (Unless stated otherwise)

Geometric tolerances	Positional tolerance	
	X	.X
0-6	±0.1	±0.05
6-10	±0.1	±0.05
10-30	±0.15	±0.10
>30	±0.15	±0.10

ANGLE ±1°

Scale:

Product design

Design	Drawn	
Workmanship	Checked	
Approvals	As mension	



戴盛通信
Dashing Com-Tek Co., Ltd

TITLE: SMA-50KWH7

Drawing No.: DS3.650.1383