

Revision	Engineering Change Description	Date	Owner
A/0	NEW	2016.09.27	ZXM

Electrical performance	
Characteristic impedance	50Ω
Frequency range	DC to 8 GHz
Standing wave ratio(VSWR)	≤ 1.15 (DC~8GHz)
withstand voltage	$\leq 0.1 \times \sqrt{f}$ (GHz) dB
working voltage	335 V rms
Test voltage	1000 V rms
Insulation resistance	$\geq 5000M\Omega$
Center pin contact resistance	$\leq 3m\Omega$
Conductor contact resistance	$\leq 2.5m\Omega$
Center conductor retention force	$\geq 0.28N$
Intermodulation 3rd order	N/A
Mechanical and environment	
Temperature range	-40~+155℃
Salt spray test time	48H
Airtight	N/A
durability	≥ 500 cycles

Materials		
Connector parts	Material	Plating
Center contact	QBe	Au
Outer contact	brass	Au
Dielectric	PTFE	

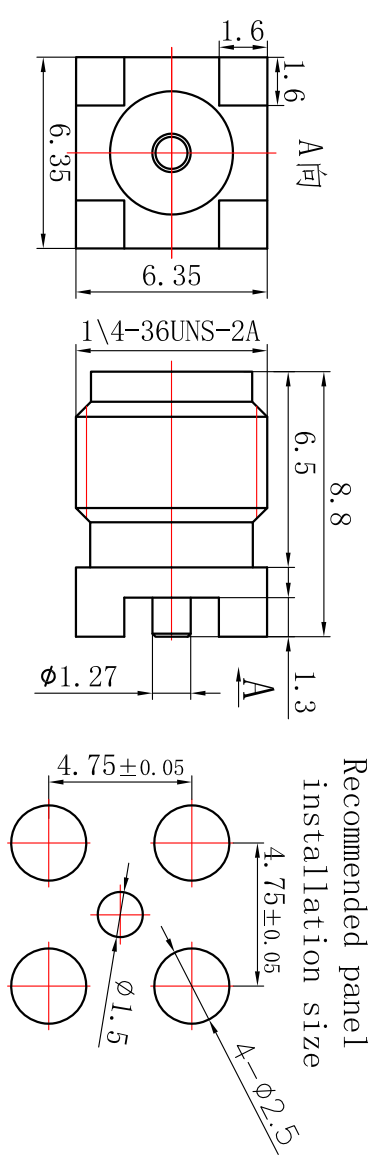

CAD GENERATED DRAWING,
DO NOT MANUALLY UPDATE

Any statements in this article shall not be interpreted as suggesting infringement of existing patents. Individual values may vary depending on factors including but not limited to application, design, cable type, assembly, and others workmanship

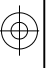
STANDARD TOLERANCES (Unless stated otherwise)		Product design	
Geometric tolerances	Positional tolerance	Design	Drawn
		Workmanship	Checked
ANGLE $\pm 1^\circ$	0-6	± 0.1	± 0.05
	6-10	± 0.1	± 0.05
Scale:	10-30	± 0.15	± 0.10
	>30	± 0.15	± 0.10
As mention		 	

戴盛通信
Dashing Com-Tek Co., Ltd

TITLE: SMA-50KHD SMT

Drawing No.: DS3.650.1408

Company website: <http://www.daisheng.net> / Email: ds168@daisheng.net