

Reversion	Engineering Change Description	Date	Owner
A/0	NEW	2017.12.09	ZXM

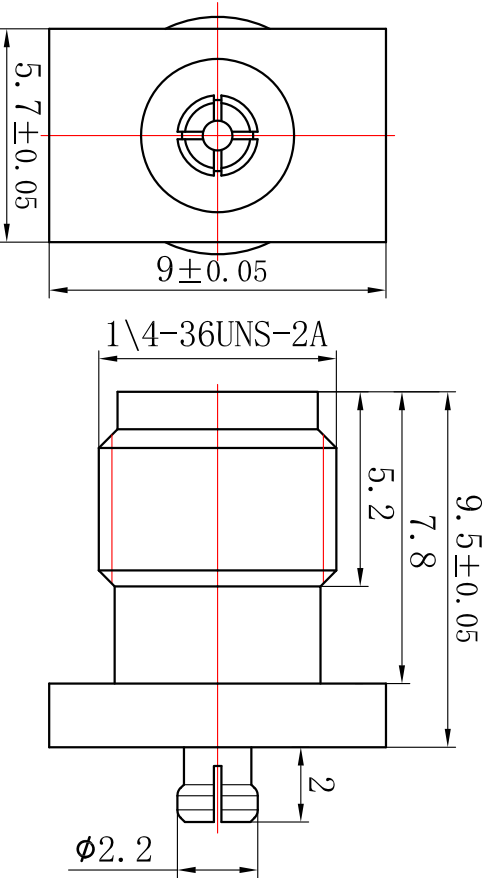

Electrical performance	
Characteristic impedance	50 Ω
Frequency range	DC to 8 GHz
Standing wave ratio(VSWR)	≤1.15 (DC~8GHz)
withstand voltage	≤0.1 x √f (GHz) dB
working voltage	335 V rms
Test voltage	1000 V rms
Insulation resistance	≥5000M Ω
Center pin contact resistance	≤3m Ω
Conductor contact resistance	≤2.5m Ω
Center conductor retention force	≥0.28N
Intermodulation 3rd order	N/A

Mechanical and environment	
Temperture range	-40~+155℃
Salt spray test time	48H
Airtight	N/A
durability	≥500 cycles

Materials		
Connector parts	Material	Plating
Center contact	QBe	Au
Outer contact	brass	Au
Dielectric	PTFE	



--	--	--	--	--	--	--	--

CAD GENERATED DRAWING, DO NOT MANUALLY UPDATE		STANDARD TOLERANCES (Unless stated otherwise)		Product design		<div>  <b>戴盛通信</b>  Dashing Com-Tek Co., Ltd </div>	
Any statements in this article shall not be interpreted as suggesting infringement of existing patents. Individual values may vary depending on factors including but not limited to application, design, cable type, assembly, and others workmanship		Geometric tolerances		Design			
		Positional tolerance		Drawn			
		ANGLE ±1°		Workmanship			
		Scale:		Checked		TITLE:	
				Approvals		Drawing No.:	
				As mension	 	DS3. 650. 1593	
				Company website: <a href="http://www.daisheng.net">http://www.daisheng.net</a> / Email: <a href="mailto:ds168@daisheng.net">ds168@daisheng.net</a>			